

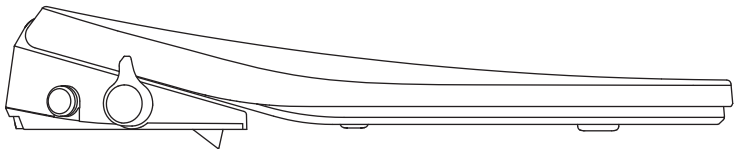

**TSE02B**  
(TB002)



# USER MANUAL

## Bidet Seat

[WWW.WINFIELDPRODUCT.COM](http://WWW.WINFIELDPRODUCT.COM)

# Contents

---

- Thank you for you purchasing our washing cover plate.  
please read the manual carefully and use product correctly
- Please keep it in a convenient place

Safety notes .....	1
Product description .....	2
Product dimension .....	2
Component description .....	3

**Before use**

Installation steps .....	4
Function introduction .....	6

**Installation and use**

Product technical specification .....	7
Faults and solutions .....	7
Cleaning and maintenance .....	8
Warranty Card .....	10

**Other matters**

## Safety notes

Read the safety instructions carefully before use so as to properly use the product.  
Note the following warnings relevant to the safety.

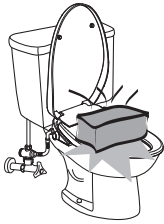

Do not place heavy objects on the toilet seat or the toilet cover

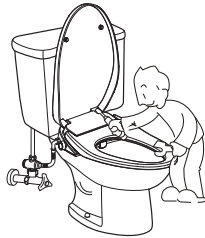
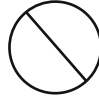

Do not disassemble, repair and modify products by without authorization.

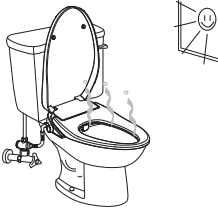
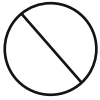

Do not place this product in direct sunlight.

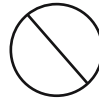

Do not bend or twist the water supply hose.

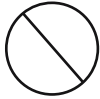

Do not lean against the toilet lid when in use

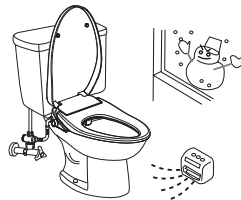

The room temperature of toilet shall be above 0°C.

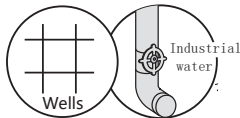
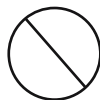

Do not connect to the substandard water pipe.



Please clean with the diluted kitchen cleaning agent and do not use the following items: Benzene, paint thinner, detergent powder, nylon brush, etc.

# Product description

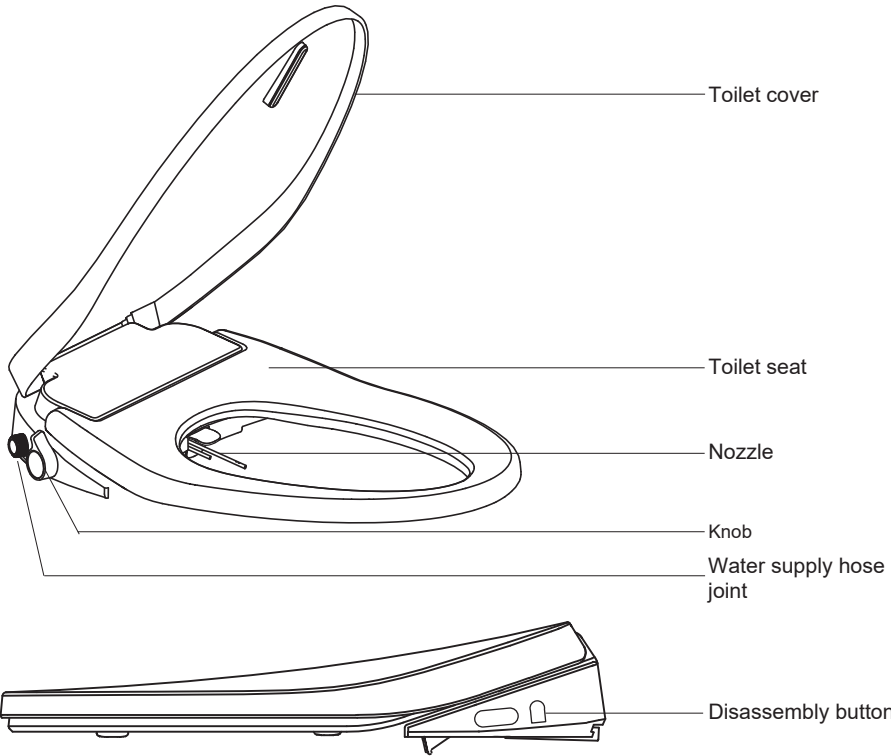

## • Product dimension drawing

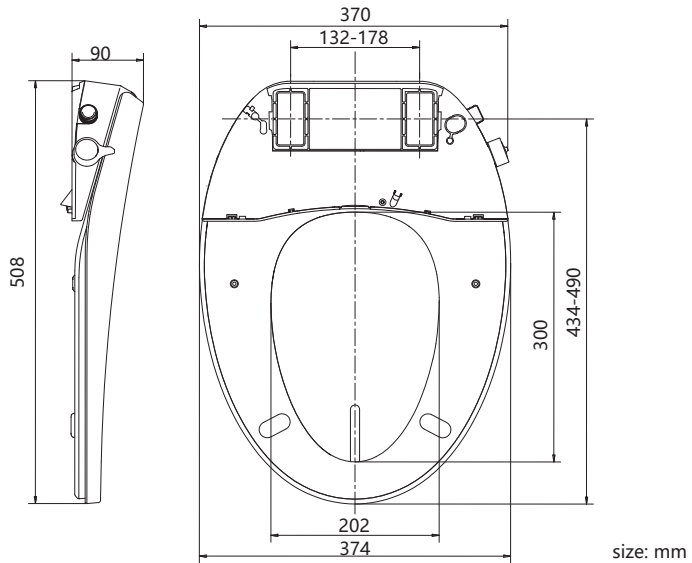

# Component description

---

1. Cover plate

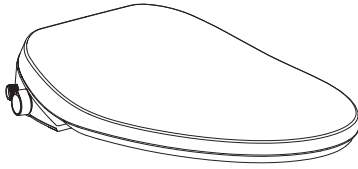

2. Installation template

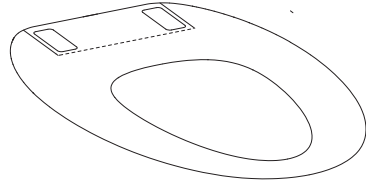

3. Fixation part



Connecting bolt (2)



Adjustment sheet (2)



Plastic TAB(2)

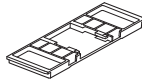

Fixing plate



Rubber bushing(2)

4. Adapter

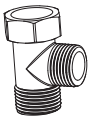

5. Water inlet hose



6. User manual

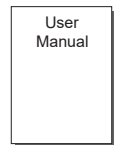

# Installation steps

## • Installation tools



Cross screwdriver

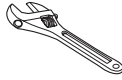

Monkey wrench



Barrel and rag

## • Attention before installation

1. Water pressure range: 0.1-0.75MPa, please follow the instructions.
2. Corner valves shall be located close to the location where this product is installed and disassembled.
3. Please use the braided hose that comes with the product to prevent water leakage.
4. When installing braided hose, be careful to prevent the black gasket falling out.

## • Installation Procedure

1. Loosen the nut connecting and remove the old cover.



2. Place the mounting template on the ceramic as shown. Align it with the rim of toilet.

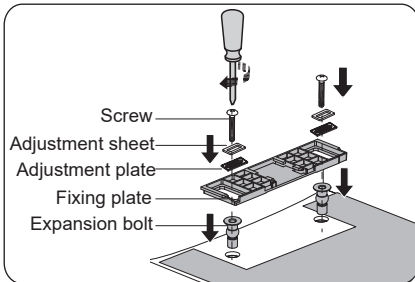
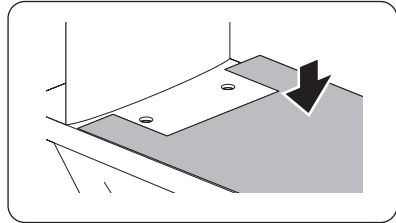

3. ① Insert the expansion bolt into ceramic hole;  
② Place fixing plate in notch part of template;  
③ Place adjusting sheet and plate in fixing plate;  
④ Align expansion bolt hole, and tighten up;

5. Slightly push the cover into fixing plate until you heard "click", indicating that the cover has been installed in place.

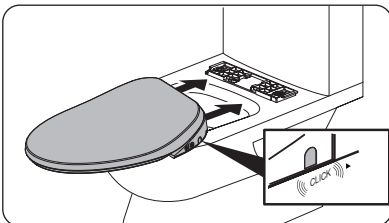

6. Close the water valve;

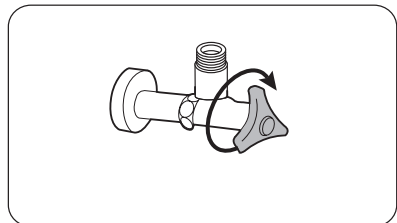

# Installation steps

7. Install braided hose;

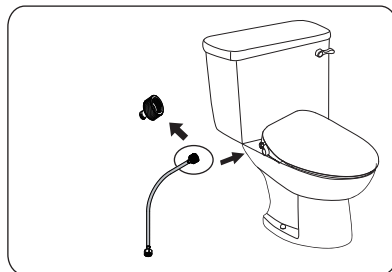

① When the ceramic is similar to the figure above, we suggest connecting the straight end of the hose to the cover

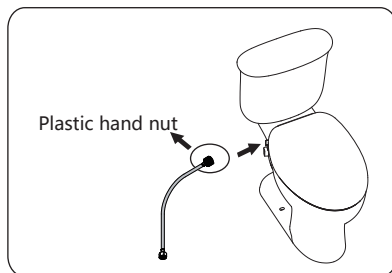
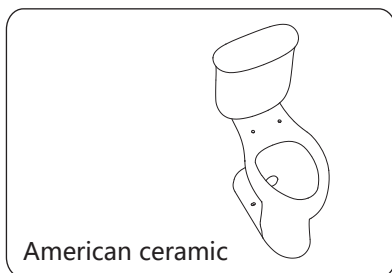

② When the ceramic is similar to the figure above, we suggest connecting the elbow end of the hose to the cover

8. Connecting flexible hose ;

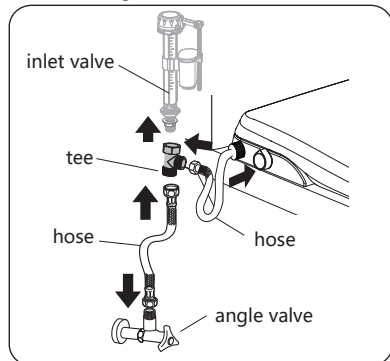

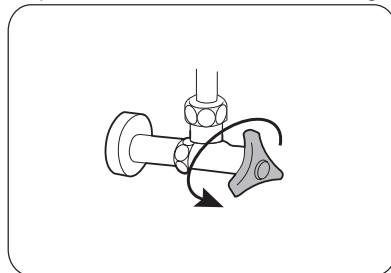

9. Open the valve to check water leakage ;

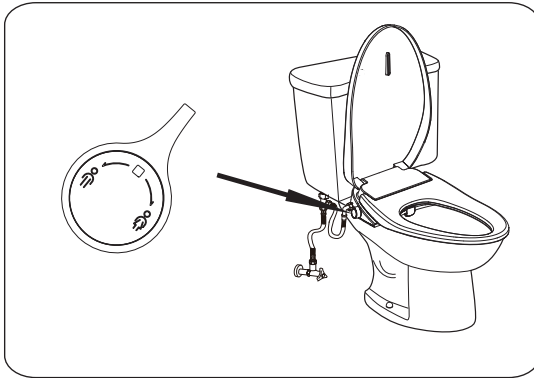

# Installation steps

10. Turn on the knob to check whether the nozzle is protruding;



-  Prohibition
1. It is strictly prohibited to move the product from the toilet cover, otherwise easy to cause mechanical failure.
  2. It is strictly prohibited to connect hot water above 40 C and cold water that may lead to icing.

## Function introduction

### • Konb functin

1、 Rinse functin

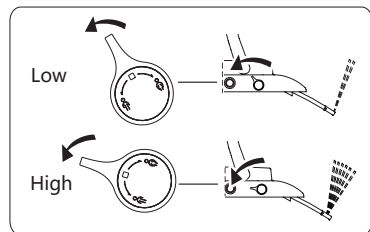
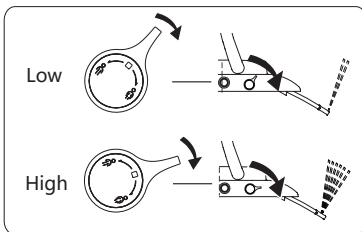

Bidet/Hip rinsing

Rotating knob to adjust amount of water

**Note:** Please open the knob to the maximum before use, and then adjust the amount of water and rinsing force through the knob.



## Product technical specification

Items		Description
Model		TSE02B
Water supply pressure		0.1 ~ 0.75MPa
Water supply temperature		5 ~ 35°C
Ambient temperature		0 ~ 40°C
Net weight		About 2.2kg
Package dimensions		525×395×110mm
Cleaning device	Water amount regulation	Stepless regulation
	Anti-backflow device	Anti-siphon valve
Others	Antibacterial material	Nozzle and seat
	Control operation	Knob

## Faults and solutions

Phenomenon	Possible cause	Solution
Low flushing	Knob is not completely turned on.	Increase knob regulating angle.
	Water pressure too low	Contact relevant departments to solve water pressure problems
Turn on knob and no the water comes out	Vavle off	Open the vavle
	The filter of the water inlet pipe is blocked	Clean the filter of the water inlet pipe
	Nozzle clogging	Remove the nozzle and clean
Spary rod cannot reset	Water quality is too bab to blocking the spary rod	Clean spary rod
Base leaking	Water pressure too high	Contact relevant departments to solve water pressure problems

## Cleaning and maintenance

---

### • Manual cleaning of spray tube

- Gently pull out the nozzle and dip the neutral detergent with a soft cloth, sponge or small brush.
- Gently support the nozzle, wipe the spray tube and nozzle.

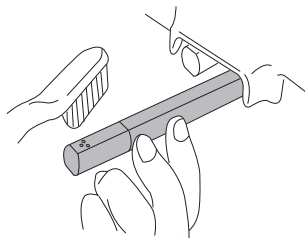

### **i** Tips:

- Make sure that the corner valve close off before you clean the filter screen ;
- Clean the filter screen when the water flow is less than normal hours.
- During cleaning process, the product must be thoroughly separated from the water inlet hose;
- Reinstall the filter screen in reverse order after cleaning.

### • Product surface cleaning

- Wipe the product surface with a sponge or soft cloth dampened with room temperature water or a neutral detergent.
- Lift the upper cover and the seat ring when cleaning other parts with cleaning agents.
- Do not put cover on before the cleaning agent in the ceramic toilet is completely washed, otherwise the surface may be corroded by the evaporation of cleaning agent.





**Winfield Products**

1689 E. Mission Blvd., Pomona, CA 91766

support@winfieldproduct.com

www.winfieldproduct.com